



Fabrix and MVRDV open TONI at Berlin's Atelier Gardens

Sitting on the edge of Berlin's former Tempelhof Airport, TONI is the new collaborative work and event space built for a new way of working.

25/10/2022

Under London-based investor and developer **Fabrix's** direction, architectural practices **MVRDV** and **Hirschmüller Schindeler Architekten** have developed TONI into a collaborative work and event premise residing in Atelier Gardens – a six-acre campus built for social and regenerative entrepreneurship, with a focus on human and planetary wellbeing.

Now a “campus for pioneers of change”, Atelier Gardens was crafted on the back of meticulous planning and preparation to protect vestiges sitting within one of Europe's film oldest studios and onetime home to Berliner Union Film Ateliers (BUFA). TONI is one of the five former studios on campus, and has been transformed into an innovative and progressive hub suitable for organisations including the likes of Greta Thunberg's Fridays for Future and Danish alternative business school Kaospilot+.

“TONI is a space where organisations of all sizes – from corporates to local social enterprises – can host events, workshops, awaydays and more while plugging into the diverse and innovative community we are cultivating here at Atelier Gardens,” comments Clive Nichol, CEO at Fabrix.

“The world of work is being radically rethought – along with many other aspects of our societies. Traditional approaches to workspace simply don’t meet the needs of forward-thinking organisations that are looking to put people and planet at the heart of what they do.”



Dutch-practice MVRDV devised a sophisticated system of overhead lights and colourful curtain railings made from acoustic fabrics and translucent to refresh TONI, leaving the original brick structure untouched. The result is a vibrant workspace which provides privacy as well as functionality, and complements the building’s new interior finish.

Jacob van Rijs, founding partner of MVRDV said: “Our goal with the architecture was to reflect this spirit – at once respecting the site’s history and sustainably preserving the heritage structures, while also bringing an exciting transformation.”

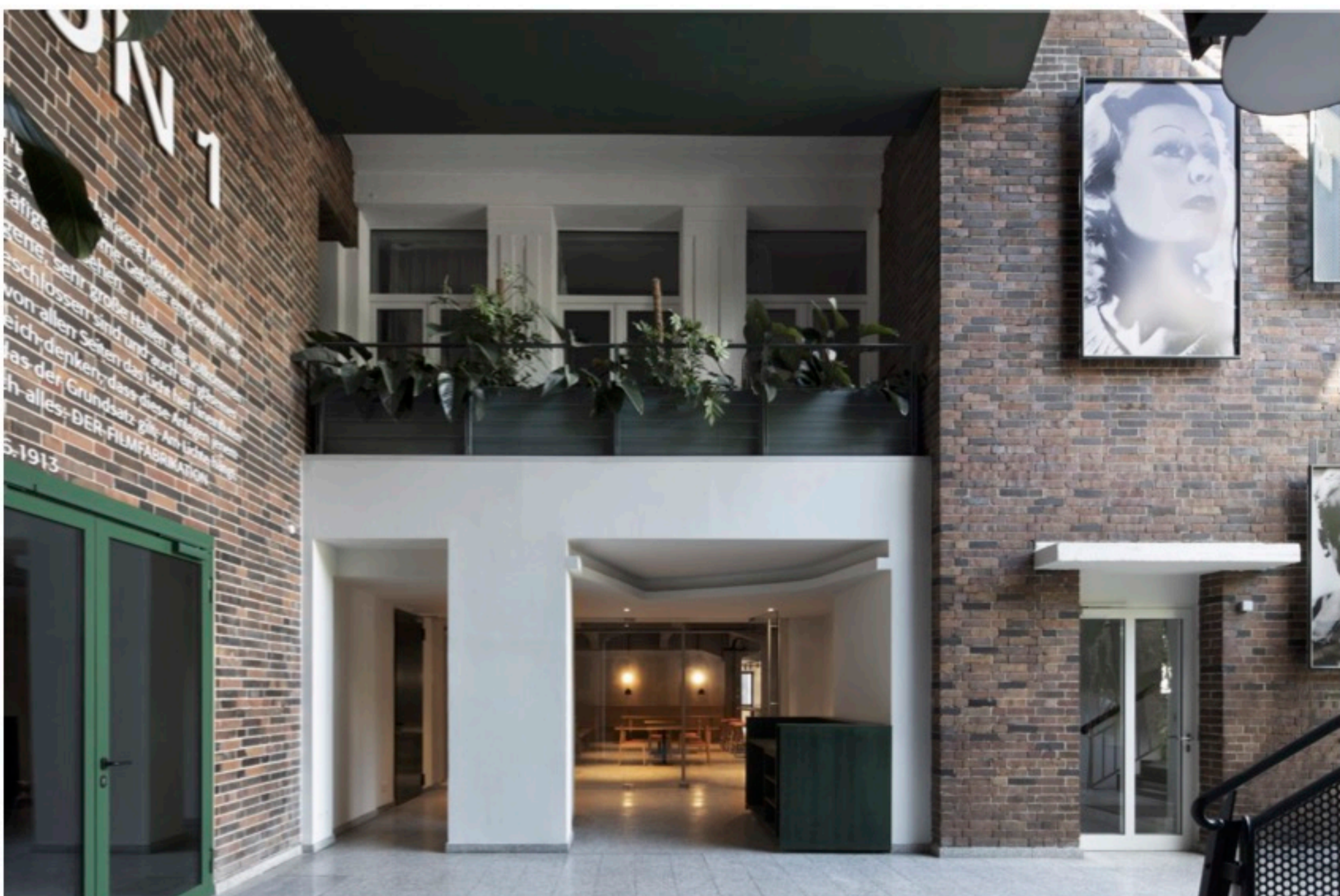

British landscape designers Harris Bugg Studio were brought into the picture to implement a re-greening strategy. Outside of TON1, large slabs of concrete have been broken up to increase the earth's permeability to let nature grow, and restrict throughfare to vehicles. Rooftop gardens and green plazas have also been dotted around the building, as well as rainwater collection points. Sustainability measures continue inside with the implementation of eco-toilets, a water recycling system and a more energy-efficient, natural ventilation system.

Fabrix's next project for completion is House1, located at the entrance to the Atelier Garden campus. Current plans include a garden and rooftop pavilion. Completion is due autumn 2023.